

**PreferredLiving**

PreferredLiving.com

**20v Cordless Pressure Washer  
User Manual and Operating Instructions  
Item Number: 21520**

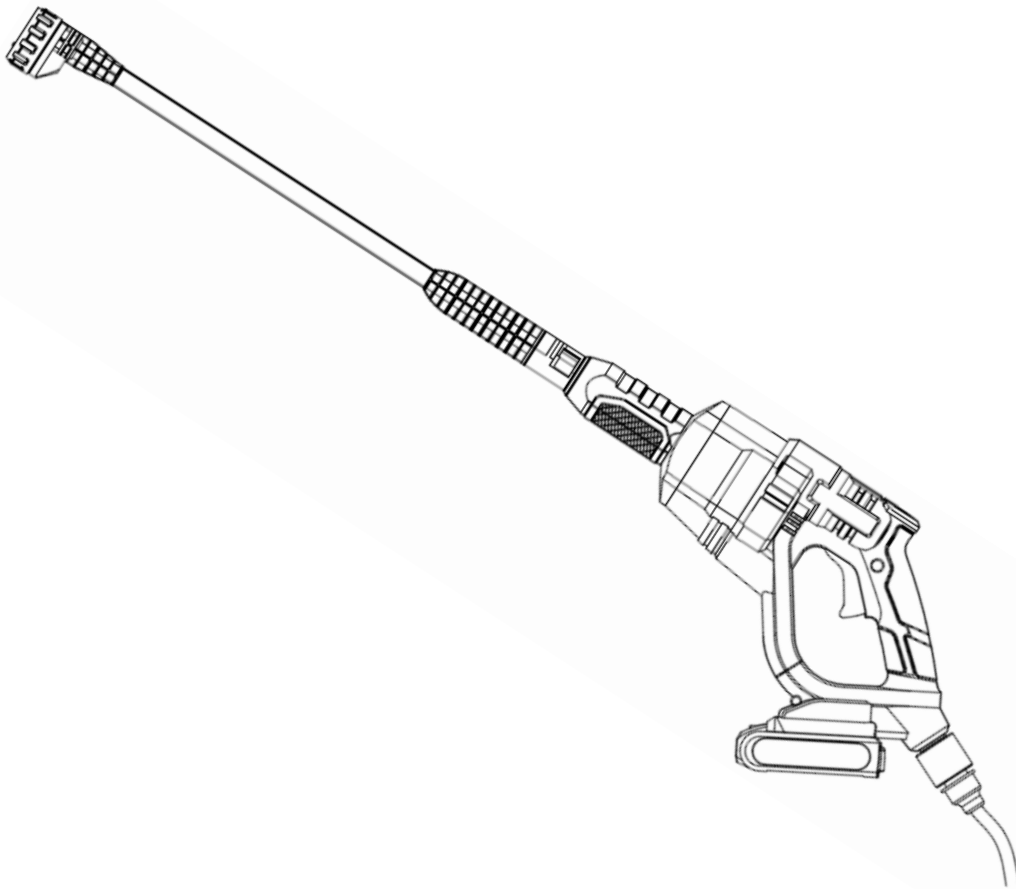

**A**

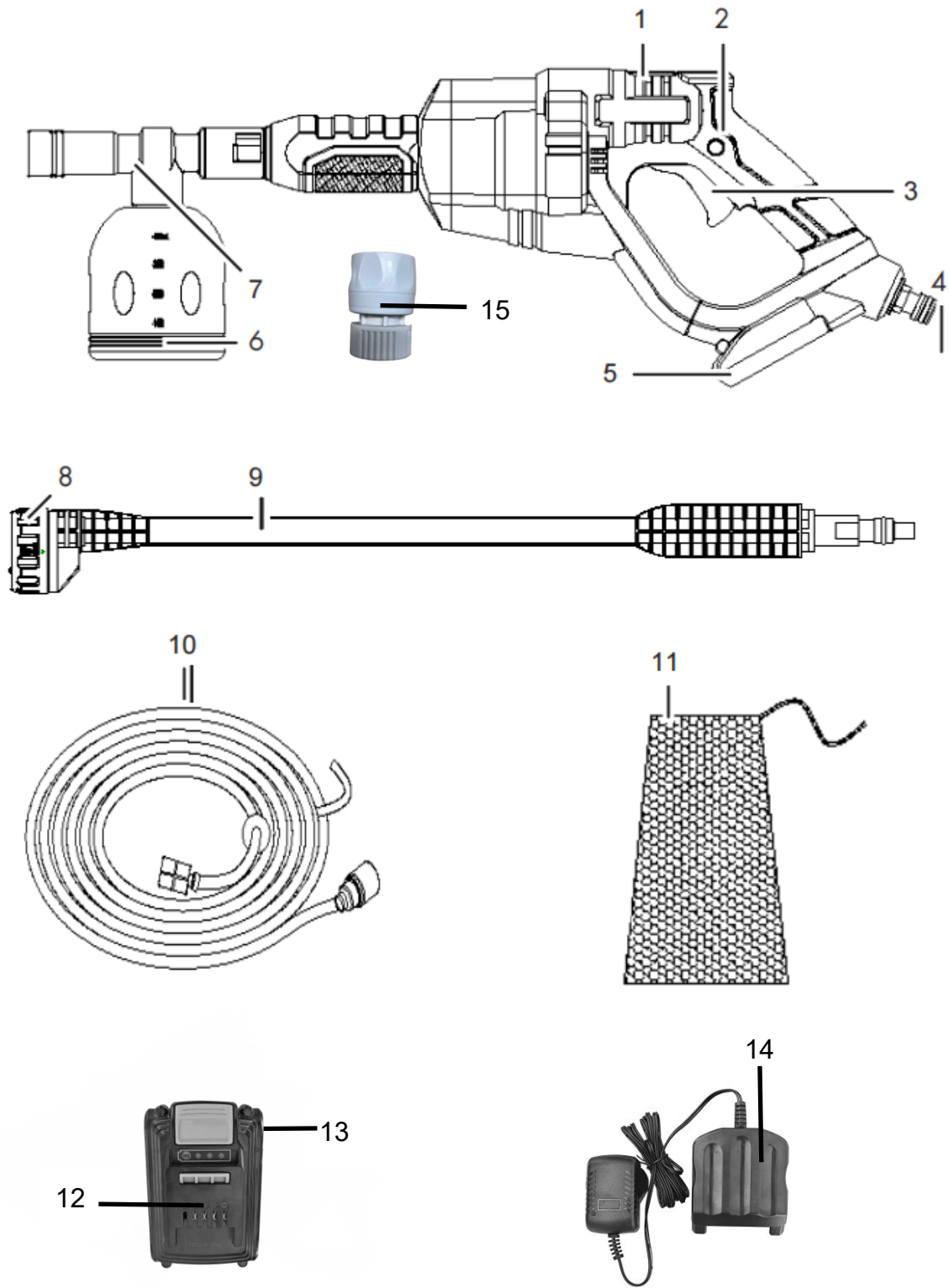

**Fig. A**

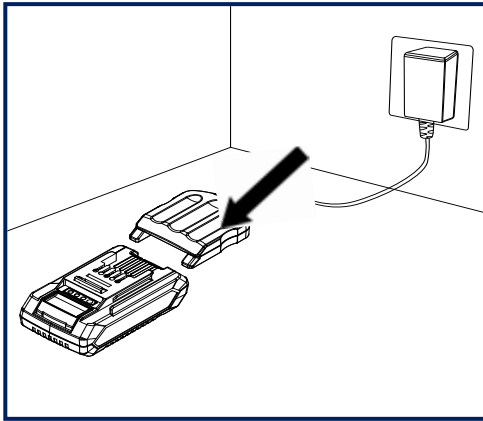

Fig.B

## Danger!

When using the equipment, a few safety precautions must be observed to avoid injuries and damage. Please read the complete operating instructions and safety regulations with due care. Keep this manual in a safe place, so that the information is available at all times. If you give the equipment to any other person, hand over these operating instructions and safety regulations as well. We cannot accept any liability for damage or accidents which arise due to a failure to follow these instructions and the safety instructions.

## 1. Safety information

The corresponding safety information can be found in the enclosed booklet.

### Danger!

**Read all safety regulations and instructions.** Any errors made in following the safety regulations and instructions may result in an electric shock, fire and/or serious injury.

**Keep all safety regulations and instructions in a safe place for future use.**

### Explanation of the warning signs on the machine



Warning!



Before beginning work, familiarize yourself thoroughly with all the operating elements, particularly with how they function and operate. Ask a specialist if necessary. Please read and comply with the instruction manual for the device!



Noise output level LWA



Li-Ion Recyclable material Li-ion



Li-Ion Do not throw the batteries in household waste.

The crossed-out wheeled bin symbol indicates that the item should be disposed of separately from household waste.

The item should be handed in for recycling in accordance with local environmental regulations for waste disposal. By separating a marked item from household waste, you will help reduce the volume of waste sent to incinerators or land-fill and minimize any potential negative impact on human health and the environment.

## General notes on safety

- Do not permit children to use the pressure washer. It is not a toy. Close attention is necessary when used near children.
- This machine can be used by people with reduced physical, sensory or mental capabilities or lack of experience and knowledge if they have been given supervision or instruction concerning use of the machine in a safe way and understand the hazards involved.
- Only use this machine after reading and understanding these instructions.
- Do not allow untrained users to operate this pressure washer
- In the case of a malfunction or defect during operation, the device must be switched off immediately and the battery removed. Then read trouble shooting of the operating instructions for possible fault causes or contact our customer service.

## Working with the equipment



**Caution: to avoid accidents and injuries:**



High-pressure washers can be dangerous if used incorrectly. The jet must not be directed at persons, animals, active electrical equipment or the device itself.

- Do not direct the jet at yourself or others in order to clean clothes and shoes.
- To protect against water or dirt splashing back, wear suitable protective clothing and safety goggles.
- Do not operate the pressure washer when other people are in the immediate vicinity, other than they are also wearing protective clothes.
- Take appropriate measures to keep children away from the equipment whilst it is running.
- Do not use the equipment in the vicinity of flammable liquids or gases. Non-observance will result in a risk of fire or explosion.

- Do not spray combustible liquids. Risk of explosion.
- If you come into contact with cleaning agents, rinse with plenty of clean water. **Burn hazard!**
- Please be aware of the increased risk of tripping up when using your pressure washer with the suction hose.
- Do not run over, crush or kink the suction hose. There is a risk of damage and therefore a risk of injury to you.
- Do not use for cleaning windows.
- Store the equipment in a dry place and out of reach of children.



**Caution! To avoid damage to the equipment and any possible person injury resulting from this:**

- Do not work with damaged or incomplete equipment, or with equipment that has been converted without the approval of the manufacturer.
- Before initial operation, have a specialist check that the required electrical protection measures are in place.
- Do not use the device if important parts such as the suction hose, nozzles or the spray lance are damaged.
- Protect the pressure washer from frost and dry running.
- High-pressure hoses, fittings and couplings are important for machine safety.
- Use only high-pressure hoses, fittings and couplings recommended by the manufacturer.
- Use only original accessories and do not carry out conversion work on the equipment.
- Please read the notes in the operating instructions on the topic of “maintenance and cleaning”. Any measures above and beyond these, particularly opening the equipment, are to be carried out by an authorized electrician.

**Electrical safety:**



**Caution: to avoid accidents and injuries from electric shocks:**

- Before each use, check the equipment for damage.
- Wear sturdy footwear to protect against electric shock.

**Usage and treatment of the electric tool**

- Do not overload the appliance. Use the correct tool for your work.** You will be able to work better and more safely within the given performance boundaries.
- Do not use an electric tool with a defective switch. An electric tool that cannot be switched on or off is dangerous and must be repaired.**
- Pull the plug out of the socket and/or remove the battery before making any adjustments to the appliance, changing accessories or put the appliance down.** This safety measure prevents starting the electric tool unintentionally.
- Keep unused electric tools out of the reach of children. Do not allow people who are not familiar with the appliance or who have not read these instructions to use the appliance. Electric tools are dangerous if they are used by inexperienced people.**
- Clean your electric tool carefully. Check whether moving parts are functioning properly and not jamming, whether parts are broken or damaged enough that the functioning of this electric tool is affected. Have damaged parts repaired before using the appliance. Many accidents are caused by badly maintained electric tools.**

**f) Make sure to use electric tools, accessories, attachments, etc. in accordance with these instructions. Take the conditions in your work area and the job in hand into account. Using electric tools for any purpose other than the one for which they are intended can lead to dangerous situations.**

#### **Using and handling the cordless tool**

- a) Only charge the batteries in chargers that are recommended by the manufacturer.** A charger that is designed for a certain type of battery may pose a fire risk if it is used with other types of battery.
- b) Use only the correct batteries in the electric tools.** The use of other batteries may result in injuries and a fire risk.
- c) Keep unused batteries away from paper clips, coins, keys, nails, screws and other metallic objects that could cause a short circuit between the contacts.** A short circuit between the battery contacts may cause burns or a fire.
- d) In case of incorrect use, fluid may escape from the battery. Avoid contact with it. If you touch it by accident, rinse the affected area with water. If you get the fluid in your eyes, also seek medical advice.** Leaking battery fluid can cause skin irritation or burns.

#### **Service**

**Have your electric tool repaired only by trained personnel using only genuine spare parts.** This will ensure that your electric tool remains safe to use.

#### **Additional safety instructions**

We pay a great deal of attention to the design of every battery pack to ensure that we supply you with batteries which feature maximum power density, durability and safety. The battery cells have a wide range of safety devices. Each individual cell is initially formatted and its electrical characteristic curves are recorded. These data are then used exclusively to be able to assemble the best possible battery packs. **Despite all the safety precautions, caution must always be exercised when handling batteries. The following points must be obeyed at all times to ensure safe use.**

**Safe use can only be guaranteed if undamaged cells are used. Incorrect handling can cause cell damage.**

**Important:** Analyses confirm that incorrect use and poor care are the main causes of the damage caused by high performance batteries.

#### **Important safety instructions for battery cartridge**

1. Before using the battery cartridge, read all instructions and cautionary markings on battery charger, battery, and product using the battery.
2. Do not disassemble the battery cartridge.
3. If the operating time has become excessively shorter, stop operating immediately. It may result in a risk of overheating, possible burns, and even an explosion.
4. If electrolyte gets into your eyes, rinse them out with clear water and seek medical attention right away. It may result in loss of your eyesight.
5. Do not short the battery cartridge:
  - (1) Do not touch the terminals with any conductive material.
  - (2) Avoid storing battery cartridges in a container with other metal objects such as nails, coins, etc.
  - (3) Do not expose the battery cartridge to water or rain. A battery short can cause a large current flow, overheating, possible burns, and even a breakdown.

6. Do not store the tool and battery cartridge in locations where the temperature may reach or exceed 50 °C (122 °F).
7. Do not incinerate the battery cartridge even if it is severely damaged or is completely worn out. The battery cartridge can explode in a fire.
8. Be careful not to drop or strike the battery.
9. Do not use a damaged battery.
10. The contained lithium-ion batteries are subject to the Dangerous Goods Legislation requirements. For commercial transports e.g. by third parties, forwarding agents, special requirements on packaging and labeling must be observed. For the preparation of the item being shipped, consulting an expert for hazardous material is required. Please also observe possibly more detailed national regulations. Tape or mask off open contacts and pack up the battery in such a manner that it cannot move around in the packaging.
11. When disposing of the battery cartridge, remove it from the pool and dispose of it in a safe place. Follow your local regulations relating to the disposal of batteries.
12. Use the batteries only with the products specified by the manufacturer. Installing the batteries to non-compliant products may result in a fire, excessive heat, explosion, or leak of electrolyte.
13. If the tool is not used for a long period of time, the battery must be removed from the tool.

**CAUTION: Only use genuine batteries.** Use of non-genuine batteries, or batteries that have been altered, may result in the battery bursting causing fires, personal injury, and damage. It will also void the warranty for the tool and charger.

**Tips for maintaining maximum battery life**

1. Charge the battery cartridge before completely discharging. Always stop tool operation and charge the battery cartridge when you notice less tool power.
2. Never recharge a fully charged battery cartridge. Overcharging shortens the battery service life.
3. Charge the battery cartridge with room temperature at 10 °C – 40 °C (50 °F – 104 °F). Let a hot battery cartridge cool down before charging it.
4. Charge the battery cartridge if you do not use it for a long period (more than six months).

**Important safety instructions for Charger**

1. Use only the voltage specified on the charger.
2. Before charging, read the instructions carefully.
3. Before charging the battery, first connect the power cable to the mains and then connect the battery pack to the charger. After the battery has been fully charged, disconnect the power supply after removing the battery pack from the charger.
4. This device is for indoor use only. Water, rain, or moisture should be avoided. Any damage caused by improper use is the sole responsibility of the user. The rules for avoiding accidents and the accompanying safety instructions must be observed.
5. The charger charges the following battery packs.

Battery charger Model number.	Battery pack	
	Model	Volt
8066-CHA	DC11-2100500U	100-240V AC,50/60HZ
<ul style="list-style-type: none"> <li>• Do not charge non-rechargeable batteries with this device.</li> </ul>		

6. SAVE THESE INSTRUCTIONS. This manual contains important safety information and instructions for using the battery charger.

7. CAUTION: Risk of explosion if battery is improperly replaced. Replace the battery only with batteries of the same type.
8. Do not expose the charger to rain, snow and other extreme weather conditions. Do not use the power tools in damp or wet locations.
9. Using an accessory that is not manufactured or recommended by the charger manufacturer could result in fire, electric shock or personal injury.
10. To reduce the risk of damage to the cord and plug, pull the plug and not the cord when disconnecting the charger from the mains.
11. Make sure that the cable is laid in such a way that it cannot be stepped on, tripped over, damaged or pulled in any other way.
12. Do not use the charger with a damaged cord or plug. In the event of any damage, they must be replaced immediately.
13. Do not use the charger if it has been hit hard, dropped or damaged in any way, take it to an authorized customer service center.
14. Do not disassemble the charger. Bring it to customer service if it needs to be repaired or serviced. Incorrect assembly could result in electric shock or fire.
15. To reduce the risk of electric shock, unplug the charger from the wall socket before servicing or cleaning it.
16. Charging should only occur when the battery pack is between 32 ° F (0 ° C) and 95 ° F (35 ° C).
17. The ventilation of the charger must never be covered or closed with a foreign object.
18. The charger works with normal household electricity. Do not use any other mains voltage!
19. WARNING: The parts inside the charger are live and create a risk of electric shock. Do not insert anything into the charger connections!
20. Unplug the charger immediately if you notice smoke or flames!
21. Keep the charger away from children!

**Do not lose these safety instructions**

## 2. Layout and items supplied

### 2.1 Layout (Fig. A)

1	Ventilation slits	9	Spray lance
2	Release button	10	Suction hose with filter basket
3	Switch lever	11	Mesh bag
4	Water connection	12	Rechargeable battery
5	Guide rail	13	Release button
6	Cleaning agent container	14	Charger
7	Cleaning agent nozzle	15	Quick hose connector
8	Nozzles		

#### Items supplied

Please check that the article is complete as specified in the scope of delivery. If parts are missing, please contact our service center or the sales outlet where you made your purchase at the latest within 5 working days after purchasing the product and upon presentation of a valid bill of purchase. Also, refer to the warranty table in the service information at the end of the operating instructions.

- Open the packaging and take out the equipment with care.

- Remove the packaging material and any packaging and/or transportation braces (if available).
- Check to see if all items are supplied.
- Inspect the equipment and accessories for transport damage.
- If possible, please keep the packaging until the end of the guarantee period.

**Danger!**

**The equipment and packaging material are not toys. Do not let children play with plastic bags, foils or small parts. There is a danger of swallowing or suffocating!**

- High pressure washer
- Spray lance
- Suction hose
- Mesh bag
- Cleaning agent nozzle with container
- Battery
- Charger
- Original operating instructions
- Quick hose connector

### 3. Proper use

This device is suitable for cleaning and irrigation.

Any other use that is not explicitly approved in these instructions may result in damage to the equipment and represent a serious danger to the user.

The equipment is designed for use by adults.

Never allow children or people who are not familiar with the instructions to use the machine. Local regulations may specify an age limit for the user.

The operator or user is responsible for accidents or damage to other people or their property. The manufacturer is not liable for damages caused by unspecified use or incorrect operation. This equipment is not suitable for commercial use. Commercial use will invalidate the guarantee.

### 4. Technical data

<b>Model</b>	<b>GT-HP2002</b>
Voltage	20 V DC
Rated pressure/Working pressure (p max.)	320 PSI
Max. intake pressure (p in max)	72.5 PSI
Max. rated flow rate	0.5 GPM
Max. Suction Lift	13 ft
Nozzle Pattern	6 spray patterns (rotating nozzle)
Water discharge time	10s
Suction hose	20 ft
Cleaning agent tank volume	400 ml
Sound power level $L_{WA}$	89 dB(A) $k= 3$ dB(A)
Sound pressure level $L_{pA}$	78 dB(A) $k= 3$ dB(A)
Guaranteed sound power level, $L_{WA}$	92 dB(A)
Vibration $a_h$	$a_h \leq 2.5$ m/s <sup>2</sup> $k=1.5$ m/s <sup>2</sup>

## Noise/Vibration Information

The values for noise and vibration were determined according to EN 60335-2-54:2008+A1: 2015. The stated vibration emission value was measured in accordance with a standard testing procedure and may be used to compare one power tool to another. The stated vibration emission value may also be used for a preliminary exposure assessment.

**Warning:** The vibration emission value may differ during actual use of the power tool from the stated value depending on the manner in which the power tool is used.

Try to keep the exposure to vibrations as low as possible. Examples of measures to reduce vibration exposure are the wearing of gloves when using the tool and limiting the working hours. For this purpose, all parts of the operating cycle have to be considered (for example, times when the electric tool is switched off and times when it is switched on but running without any load).

## 5. Before starting the equipment



In keeping with current regulations, a pressure washer must never be operated off the drinking water mains supply without a controllable back flow presenter. A suitable back flow presenter in conformity with EN 12729 type BA must be used.

Water that has passed through the system is classified as undrinkable.

A back flow presenter is available in specialist shops.

A system separator (check valve) prevents the back flow of water and detergent into the drinking water pipeline.

- Employ an ordinary garden hose for the water intake and ensure sufficient length.
- Use the device on a domestic water connection with maximum pressure of 5 bar.
- You can also use the device independently of the water pipe (for example, with a rain barrel) through the integrated water suction function. This function must only be used with a suction hose with a filter basket.

### 5.1 Connecting to the domestic water connection

1. Connect the supply hose to the water supply. Let water run through the hose until no air bubbles remain. Close the tap.
2. Connect the hose coupling of the supply hose to the quick hose connector (15).
3. Connect the quick hose connector (15) to the water connector (4) on the unit.

### 5.2 Suctioning water

You can also use the device independently of the water pipe (for example with a rain barrel) through the integrated water suction function. This function must only be used with a suction hose with a filter basket.



**The device itself must not be immersed in open water sources. There is a risk of personal injury from an electric shock.**



**Do not draw in any water from natural accumulations. There is a risk of contamination from back washed cleaning agent.**

1. Connect the suction hose with filter basket (10) to the water connection (4) on the device.

2. Insert the end with the filter basket into the water collector (e.g. rain barrel). Ensure there is a sufficient and reliable water supply.

### 5.3 Bleeding the hose

Make sure that there is no air in the suction hose. Immerse the suction hose and filter basket (10) completely into the water collector (e.g. rain barrel) to bleed it.



**Do not run the washer without water.** This can damage the unit.

### 5.4 Attaching the spray lance/ cleaning agent nozzle

1. Connect the spray lance (9) or the cleaning agent nozzle (7) to the cordless pressure washer by inserting and screwing in (bayonet locking device).
2. Attachments are removed in reverse order.

### 5.5 Inserting/removing the rechargeable battery

1. To insert the battery (12) into the device, push the battery (12) along the battery connector (5) guide rail into the device. You will hear it click into place.
2. To remove the battery (12) from the device, press the release button (13) on the battery and pull the battery (12) out.

### 5.6 Charging the battery (Fig. B)

1. Take the battery pack out of the equipment. Do this by pressing the side push lock buttons (13).
2. Check that your mains voltage is the same as that marked on the rating plate of the battery charger. Insert the power plug of the charger (14) into the socket outlet. The LED turn on.
3. Insert the battery pack (12) into the battery charger (14) then the LED on charger will turn red
4. In the section entitled “Charger indicator” you will find a table with an explanation of the LED indicator on the charger.

**Note: The battery pack can become a little warm during the charging. This is normal.**

If the battery pack fails to charge, check:

- Voltage at the power socket
- Whether there is good contact at the charging contacts.

If the battery pack still fails to charge, contact our customer service center.

To ensure that the battery pack provides long service, you should take care to recharge it promptly. You must recharge the battery pack when you notice that the power of the cordless vacuum drops. Never allow the battery pack to become fully discharged. This will cause it to develop a defect.

### 5.7 Battery capacity indicator

Press the switch for the battery capacity indicator.

The battery capacity indicator shows the charge status of the battery using 3 LEDs as following:

Indicator status	Explanations and actions
1 LED is lit	The battery will be empty soon, please recharge the battery.
2 LED(s) are lit	The battery has an adequate remaining charge.
All 3 LED(s) are lit	The battery is fully charged.

## 5.8 Charger indicator

Indicator status		Explanations and actions
Red LED	Green LED	
	On	<b>Ready for use</b> The charger is connected to the mains and is ready for use; there is no battery pack in the charger.
On		<b>Charging</b> The charger is charging the battery pack in charge mode.
	On	<b>Battery pack is fully charged.</b> Charging is finished and battery pack is fully charged.

## 6. Operation



**Be prepared for the recoil force of the emitted water jet! Ensure that you are standing firmly and that you are holding the gun securely, otherwise you could injure yourself or other people.**



Never operate the pressure washer with a closed water tap. Dry running will damage the pressure cleaner!

### Switch ON/OFF.

1. Only use the device after you have connected the water supply and the connection is tight.
2. Press the release button (2) and then the switch lever (3). You can then let go of the release button (2).
3. Releasing the switch lever (3) switches off the device.



**If there is a leak in the water system, switch off the device immediately and remove the battery. Risk of electric shock! Try connecting the water again (see “Trouble shooting”).**

### Ending operation

1. After having worked with a detergent rinse the pressure washer with clear water.
2. Release the switch lever (3).
3. Remove the battery from the device.
4. Disconnect the cordless pressure washer from the water supply.
5. Press the release button (2) and the switch lever (3) to release the existing pressure in the system.

### Adjusting the nozzles

Six different nozzles can be used on the spray lance.

The nozzles can be changed by turning the nozzle attachment.

A small arrow on the top of the spray lance indicates which nozzle is currently selected.

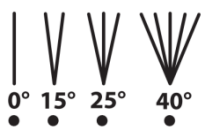

0°/15°/25°/40° spray angle



• Jet sprays upwards



• Gentle spray for watering / washing

### Using detergents

This device has been designed to be used with a neutral, biodegradable cleaning agent. Other detergents or chemical substances could impair the safety of the pressure washer and damage it. Such damage to the equipment is not covered by the guarantee.

## 7. Cleaning and Maintenance and Storage



Remove the battery before carrying out any work on the device. This also includes connecting to the water supply or trying to eliminate leaks. There is a risk of electrocution or of injury from moving parts.

### 7.1 Cleaning



**Never direct the water jet against the pressure cleaner, nor clean the pressure washer under flowing water. This could give rise to the danger of electric shock and damage the pressure washer!**

**Always keep the pressure washer clean. Do not use any detergents or solvents.**

- Always keep the ventilation slots (1) clean and free.
- Clean the device with a soft brush or damp cloth.
- If the nozzles (8) on the spray lance (9) are soiled or clogged, you can remove any foreign bodies in the nozzle using a needle. Rinse the nozzles with water to remove the foreign body.

### 7.2 Maintenance

The pressure washer is maintenance free.

### 7.3 Storage

- **Empty the cordless pressure washer completely of water.**

Disconnect the device from the water supply. Switch on the battery pressure washer for a few seconds until no more water emerges from the spray lance (9). Turn off the device.

- Store all spray lances (9) vertically with the connection side facing downwards.
- Completely empty the suction hose and filter basket (10).
- The cordless pressure washer and accessories are destroyed by frost if they are not completely emptied of water. Store the device and the accessories in a frost-resistant location.

## 8. Trouble shooting

Problem	Possible cause	Remedy
Strong pressure fluctuations	Nozzles (8) dirty/clogged	Rinse the nozzles (8) with water. If required, clean the nozzle bore hole with a needle (see "Cleaning" section).
Device does not work	Battery is flat	Charge rechargeable battery.
Leaks in the water system	Connections not correctly installed	Switch off the device and remove the battery. Reconnect the device to the water supply (see "Initial start-up")
	Connection pressure too high	Only connect the device to a domestic water connection with maximum pressure of 5 bar.

## 9. Disposal and recycling

The unit is supplied in packaging to prevent its being damaged in transit. This packaging is raw material and can therefore be reused or can be returned to the raw material system.

The unit and its accessories are made of various types of material, such as metal and plastic. Defective components must be disposed of as special waste. Ask your dealer or your local council.



Recycling alternative to the return request:

As an alternative to returning the equipment to the manufacturer, the owner of the electrical equipment must make sure that the equipment is properly disposed of if he no longer wants to keep the equipment. The old equipment can be returned to a suitable collection point that will dispose of the equipment in accordance with the national recycling and waste disposal regulations. This does not apply to any accessories or aids without electrical components supplied with the old equipment.

Preferred Living  
 2001 Sporty's Drive  
 Batavia, OH 45103  
 1-800-776-7897